

FLUSH Specs & Dimensions

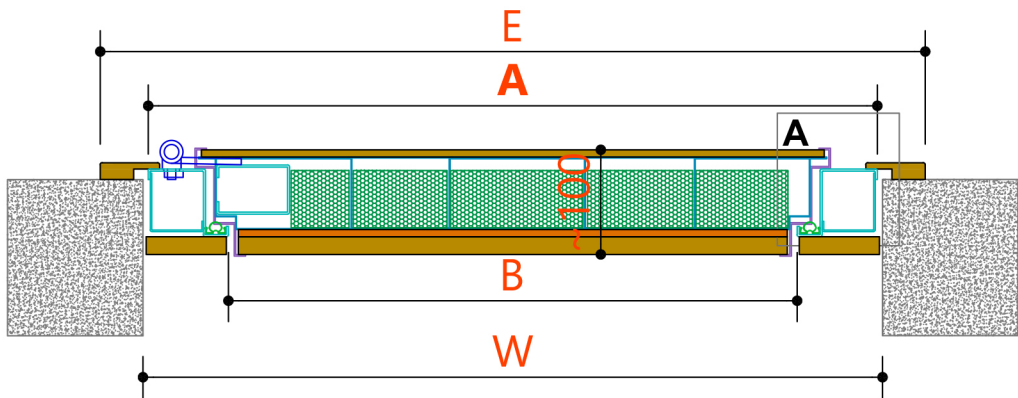

Dimensions FLUSH							
Width				Height			
W	A	B	E	w	a	b	e
	Outside Frame Dimension	Clear passage	Interior Architraves		Outside Frame Dimension	Clear passage	Interior Architraves
1000	990	836	1090	2150	2145	2068	2195
10	0	-154	100	5	0	-77	50

Dimensions made to measure per 1cm A=1400 x a=3000
All orders are executed using dimensions A & a, wall thickness, and way of opening looking from the push side

FLUSH Specifications

- Available Types**
Single Flush / Double Flush / Fixed Panels
- Door Leaf Description / Certifications**
Armoured door, 100 mm thick, with double rebate, galvanized steel shield reinforced with 3 beams, insulated with rock wool. Panel cladding: 6–8 mm on the interior side, 16–18 mm on the exterior side.
- Frame Description**
Closed-type metal frame in black color (other colors available upon request). Exterior architraves in the same color as the panel, flush with the door leaf.
- Dimensions**
Free manufacturing dimensions per cm up to 140 cm × 300 cm.
- Locking System**
Gear-operated lock system with 14 locking points (8 moving in two directions, 6 fixed) and a rotating opening limiter. Security cylinder: branded cylinder with 1 construction key and 5 owner keys.
- Hinges**
Two heavy-duty hinges, adjustable in 2 directions.
- Handles**
Handle, opening limiter, door knob, and peephole in inox or bronze color.
- Insulation**
Dropdown seal on the door leaf, sealing gasket on the frame.

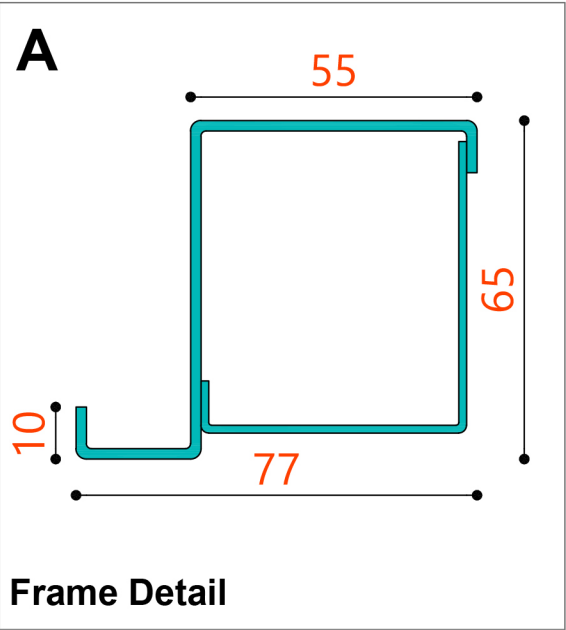
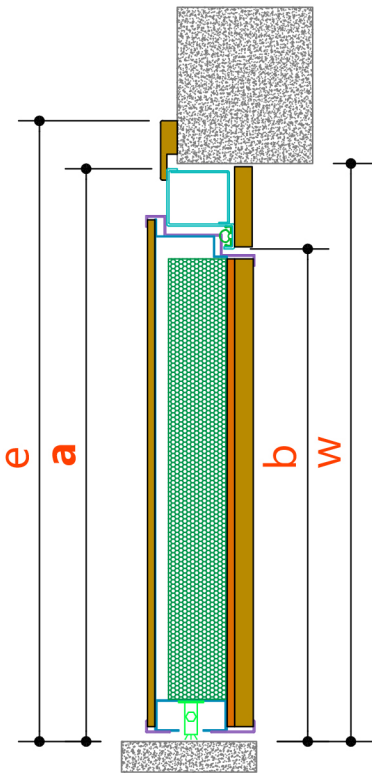

Frame Detail



FLUSH
The only flush...
armoured door